



# SN-IPR5122BZBN-M

2MP IR Bullet Network Camera (NEMA 4X)



## Key Features

- 1/2.8" progressive scan CMOS
- 2.8~12mm manual lens
- Max resolution 1920×1080 @30fps
- Support intrusion and line crossing based on human detection
- DWDR, 3D DNR, HLC, BLC, Defog
- IR distance up to 40m
- Built-in SD card slot
- 12V DC/PoE power supply
- IP67
- Anti-Corrosion design, providing reliability and longevity compared to standard NEMA 4X (Optional)

# Specification

Camera	
Image Sensor	1/2.8" Progressive Scan CMOS
Electronic Shutter	Auto/Manual, 1/5 ~ 1/20,000s
Min. illumination	Color: 0.1 Lux @ (F1.6, AGC ON) , B/W: 0 Lux @ (IR LED ON)
S/N Ratio	55 dB
Day & Night	IR cut filter
IR Distance	Up to 40 m (131.2 ft)
IR On/Off Control	Auto/Manual
Pan/Tilt/Rotation Range	Pan: 0° ~ 360°, Tilt: 0° ~ 90°, Rotation: 0° ~ 360°
Lens	
Lens Type	Manual focal
Iris	Fixed Iris
Focal Length	2.8 ~ 12 mm
F Number	F1.6
Angle of View	H: 101.9° ~ 33.6°, V: 53.6° ~ 18.9°
Video	
Max. Resolution	1920(H)×1080(V)
Encode	H.264, H.265
Streaming Capability	2 Streams
Main Stream	1920×1080, 1280×720 @ 25/30fps
Sub Stream	704×576, 640×360, 480×360, 352×288 @ 25/30fps
Bit Rate Control	CBR/VBR
Bit Rate	Main Stream: 512kbps ~ 4096kbps Sub Stream: 128kbps ~ 1536kbps
Image	
Image Adjustment	Brightness, Sharpness, Contrast, Saturation
White Balance	Auto/Manual
Mirror	Support
Exposure Mode	Auto/Manual
Day/Night Setting	Auto, Day, Night, Timing
Noise Reduction	2D/3D NR
Image Enhancement	HLC, BLC, Defog
Wide Dynamic Range	DWDR
Privacy Masking	Support

Event	
Motion Detection	Support
Intelligent Analysis	Intrusion and Line crossing detection based on human detection
Network	
Protocols	IPv4/IPv6, RTSP/RTP/RTCP, TCP/UDP, DHCP, DNS, DDNS, UPNP, ICMP, IGMP, NTP, SMTP, 802.1x, SNMP, HTTP/HTTPS, PPPOE
Interface Protocol	ONVIF, SDK
Max. User Access	4 Users
Web Viewer	<IE11, Chrome, Firefox, Microsoft Edge
Language	English, Chinese (Simplified), French, Korean, Polish, Italian, Spanish, German, Hungarian, Russian, Vietnamese, Thai, Danish, Czech, Slovak, Indonesian, Portuguese, Dutch, Hebrew, Arabic
Interface	
Network Interface	1 Ethernet (10/100 Base-T) RJ-45 Connector
SD Card Slot	Built-in, up to 256GB
Reset Button	Support
Electrical	
Power Supply	DC12V(-15%~+25%)/POE (IEEE 802.3af)
Power Consumption	Max 5 W
Operating Temperature	-25°C ~ 55°C (-13°F ~ 131°F)
Operating Humidity	Less than 90% RH
Ingress Protection	IP67, NEMA 4X (Optional)
Certifications	CE/FCC
Casing	Metal
Dimensions	232 × 80 × 80mm (9.13" × 3.15" × 3.15")
Net Weight	0.73 kg (1.61 lb)



## Dimensions (mm)

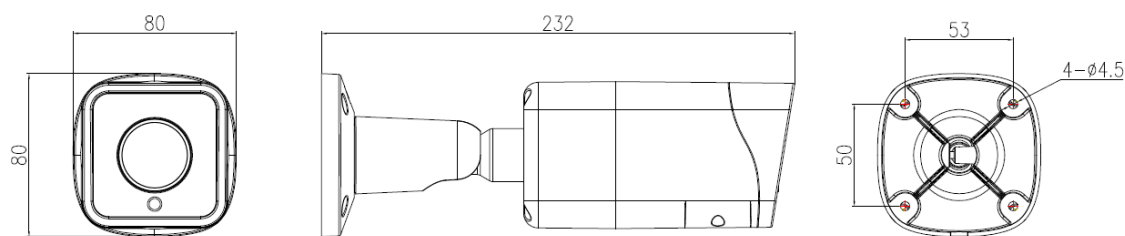

## Accessories

Optional:



SN-CBK656A  
Junction Box



SN-CBK627D  
Pole Mount